



TONONE

BROCHURE 2024

ABOUT TONONE

How can we apply our fascination for traditional mechanics and craft tools into state-of-the-art design? This quest was the starting point for the products of lighting label Tonone, known for the use of characteristic construction tools as a visual and a functional basis for innovative product design.

This vision was well illustrated by the design of the Tonone-line up: the Bolt-series, followed by the hand-blown glass series Atlas and Ella, the sturdy lamp Mr. Tubes and the LED serie Beads. In 2022, Tonone added two new series to its collection: the elegant Bella and the portable ONE. The Bridge linear LED lamp was launched in early 2024.

[READ MORE](#)

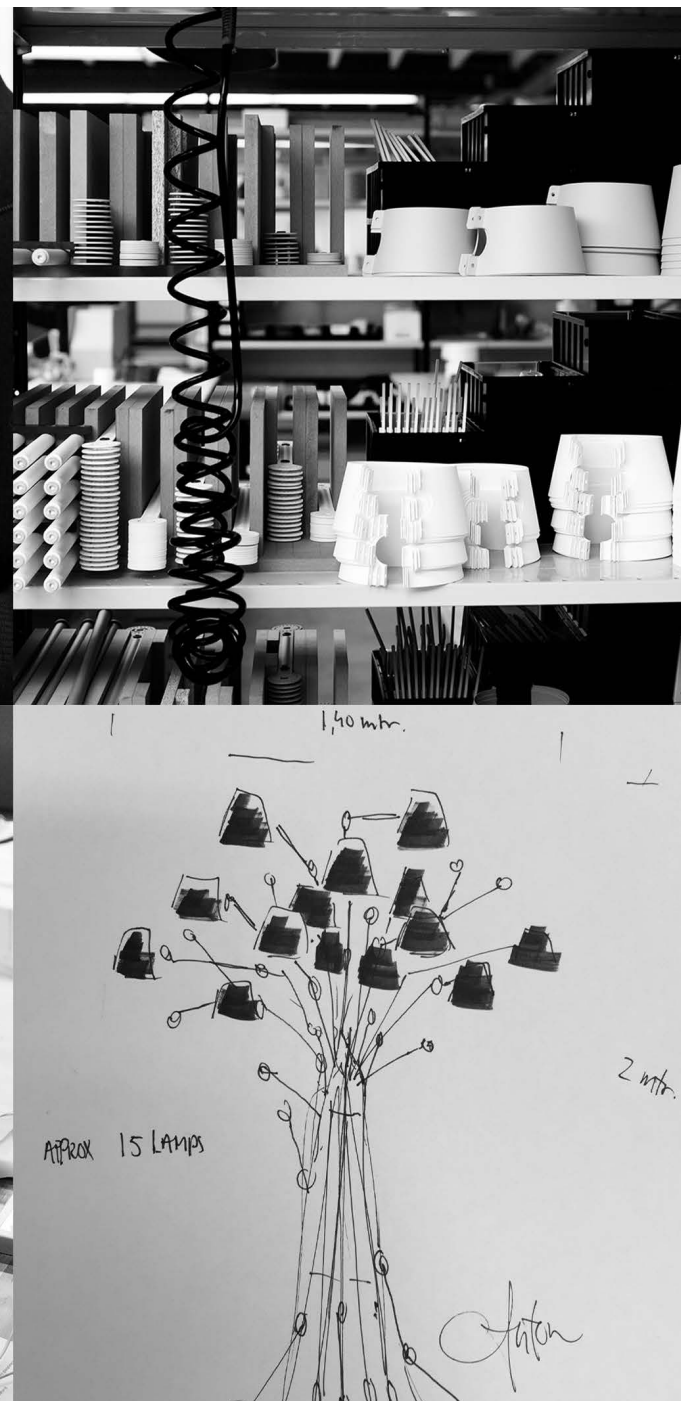

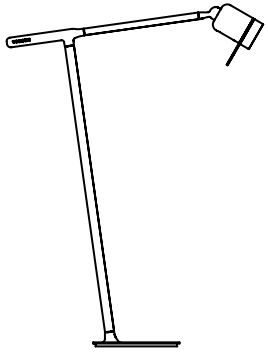

4 | ONE

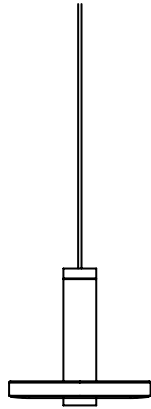

5 | BEADS

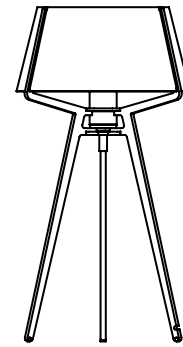

6 | BELLA

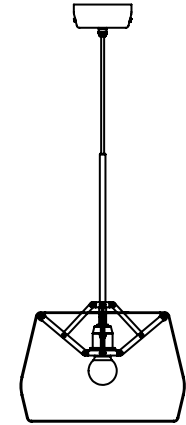

7 | ATLAS

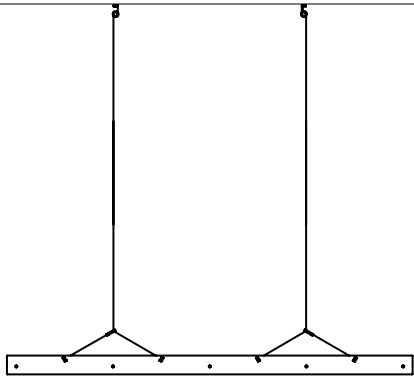

8 | BRIDGE

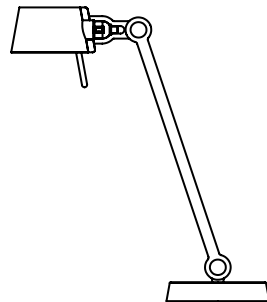

9 | BOLT

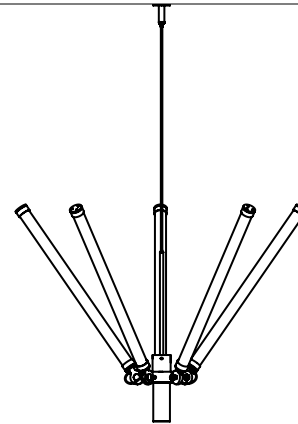

10 | MR. TUBES LED

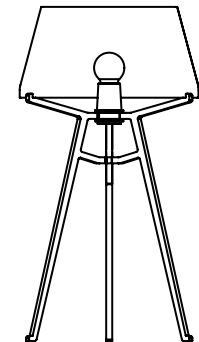

11 | ELLA

ONE

If we had to describe it in one sentence, we would say: a portable designer lamp that you can take with you wherever you go. This is far from all. ONE tells a story about decluttering, about a more sustainable lifestyle, about adventure. ONE is everywhere you go and (in theory) the only lamp you need. Only ONE.



ONE is always used in combination with one of the fixtures: Knob, Wall, Desk or Floor. The Wall and Knob fixture has a permanent place in your interior. The Floor and Desk fixtures are easy to move from one place to another as well as inside or outdoors.

At the end of every fixture you find a spheric steel magnet that allows you to attach and detach the ONE in a single move. The great advantage of this last feature is that you can direct the ONE in any position.

[MORE INFO](#)

BEADS

The Tonone Beads collection is designed to fit into any environment. The minimalist look of the fixture excels when it comes to functionality. With the rotatable and tiltable LED ring, Beads is a versatile solution for any situation.



The Beads is available as a pendant, ceiling, wall, floor or table lamp. Anton de Groof: "One day at the beach my daughter was stringing beads. I looked at her and the beads caught my eye, the shape, the simplicity. What if we convert this into a functional lighting design? After this, the Beads was born."

The lightweight Beads lamp is made of black powder-coated aluminum and is equipped with a high-quality integrated LED light source. The fixture of the lamp is made of black powder-coated steel. The temperature of the light ranges from 2100K to 2800K (dim to warm).

[MORE INFO](#)

BELLA

Bella was made to steal the show. Even without light, Bella is a highlight in your interior. Thanks to its powerful silhouette, Bella is the perfect candidate for both a modern, industrial and classic interior.

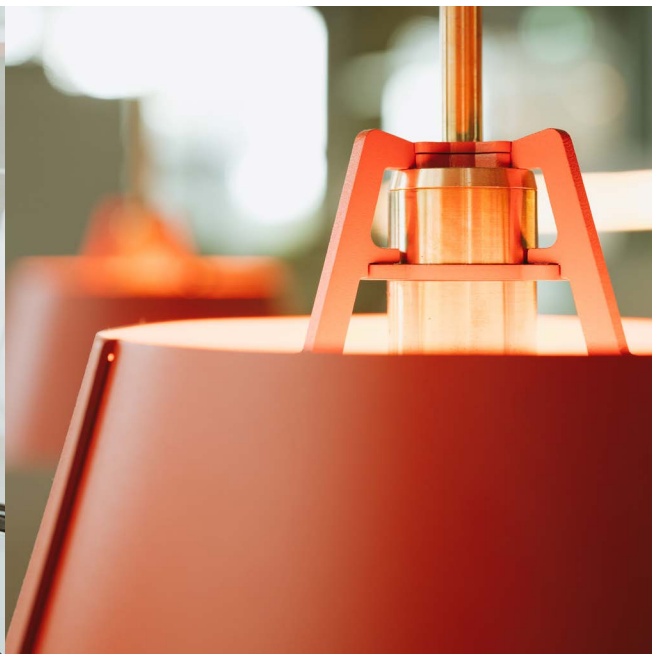

One of the things that make Bella unique is that she is (almost) completely screwless. The three legs on which Bella stands continue seamlessly toward the lamp shade where they form the ribs. In-between these ribs you will find a slot where you can clamp the loose plates, so that the separate elements come together as a whole. This construction is not only screwless, but also extremely strong.

Bella is available as a table and pendant lamp in 11 colors. To fully customize the design to your liking, you get another choice: the color of the fitting. The socket of the Bella lamp is available in brass and black.

[MORE INFO](#)

ATLAS

Atlas is an industrial yet very elegant pendant lamp. The combination of a brass hinge mechanism with a transparent, mouth-blown glass shade creates a structural lamp with a poetic character. The glass provides a natural and pleasant diffusion of light, allowing it to shine evenly and atmospherically in the room.

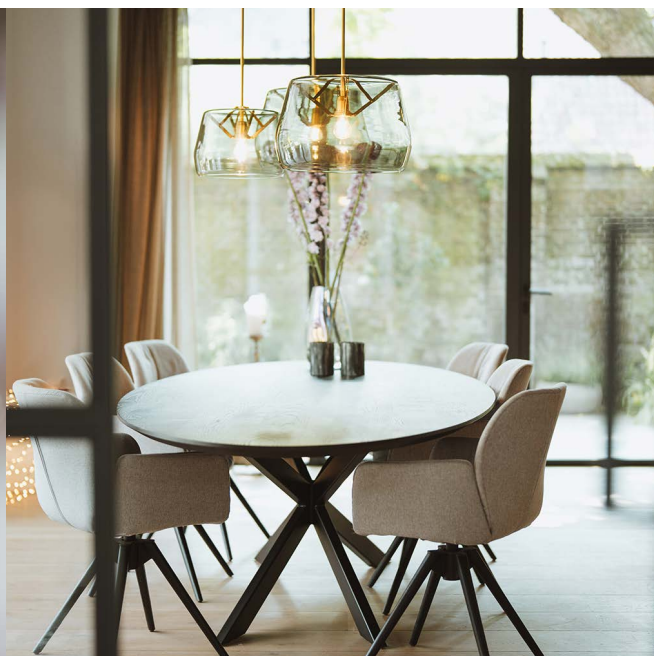

By unfolding the hinge mechanism upright, the glass shade is held up while resting on the structure. Atlas is available in two sizes: a large shade that is 450 mm wide and a smaller shade that is 350 mm wide. For the mouth-blown glass shade, you can choose between two colors: transparent glass or neutral gray glass.

[MORE INFO](#)

BRIDGE

A striking design that distinguishes itself from the current collection by a striking choice of materials. Nevertheless, the Tonone signature, bold and functional, is clearly reflected in the renewed lighting concept. Looking at the current collection, the idea arose to develop a linear lamp.

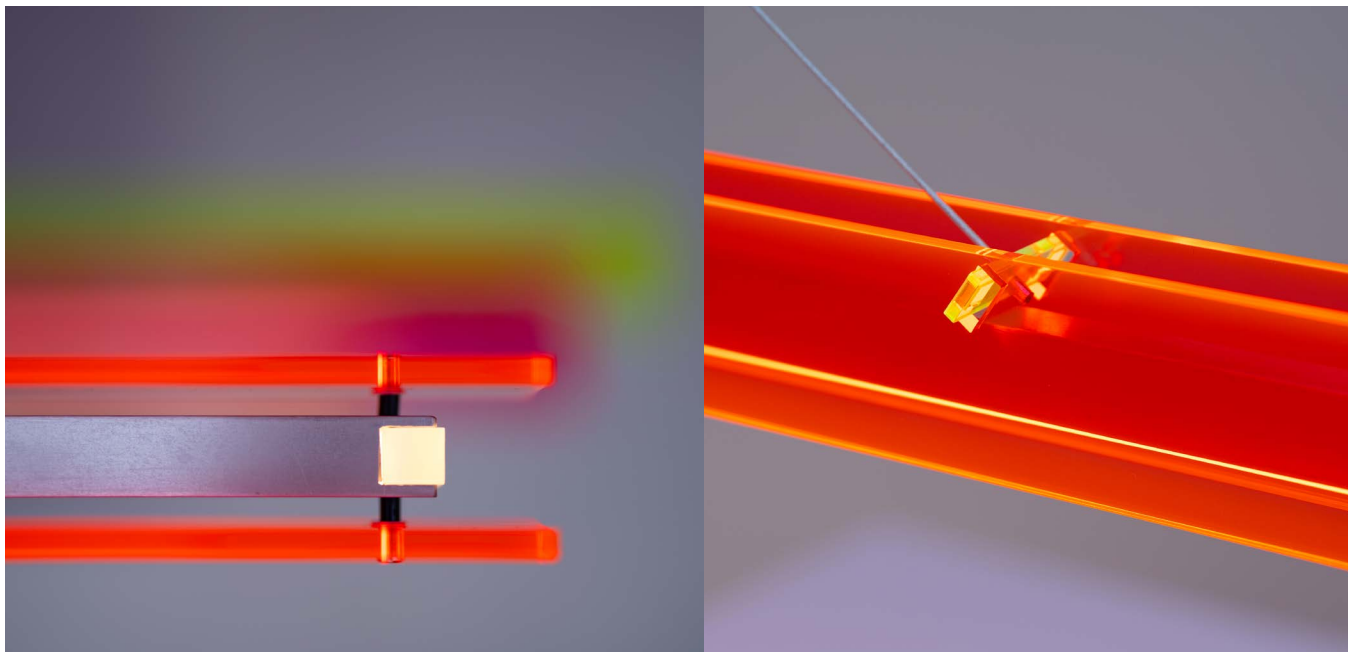
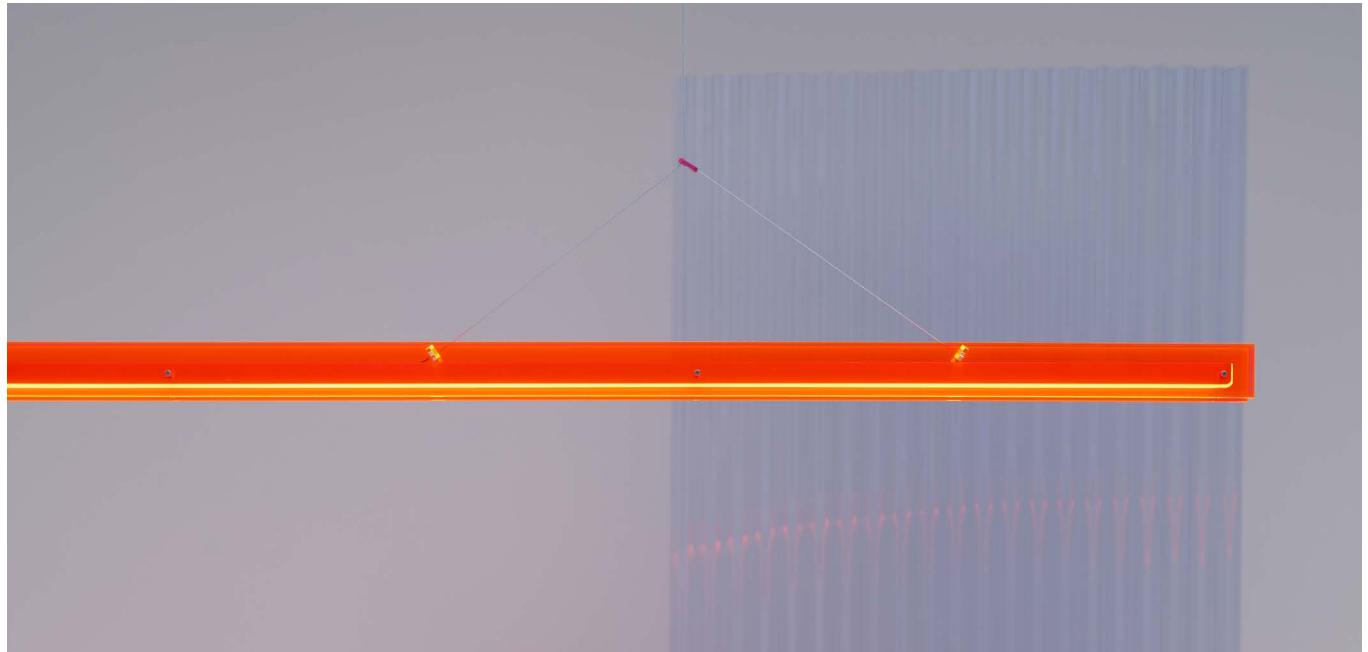

A lamp that allows for a graphic interplay of lines and with which you can experiment with composition.

Just like a real bridge, Bridge has different supports, so that the load-bearing capacity is evenly distributed along its length. Moreover, with Bridge, you don't have a power cable that catches the eye with Bridge. That's because the power is conducted by steel cables, which are also used to hang the lamp.

Bridge is made of recycled plexiglass and is available in two neon colors (Lava Orange and Toxic Green) and in an opal color (Fog White). The lengths of the lamp are 110, 150, 180 and 220 cm.

[MORE INFO](#)

BOLT

The starting point for Tonone's products is the passion for traditional mechanics. The first product line resulted from this fascination is the lamp series 'Bolt'. It is considered the most famous lighting series from Tonone and is a design from 2013. The Tonone Bolt is characterized by its functional shape and clear lines.



The industrial-looking design of the lamp features a construction with a ball hinge system. The iconic solid brass wingnut plays a major role here. The wingnut not only serves as a tool for adjusting the hinges, but is integrated into the design of the lamp and therefore represents a distinctive visual element.

Bolt features adjustable arms made of powder-coated steel and a shade made of powder-coated aluminum. The open shade ensures a nice distribution of light upwards and downwards.

The Bolt series consists of 29 different models and in 10 colors. The Bolt is available as a table, desk, floor, ceiling, wall, bed or pendant lamp.

[MORE INFO](#)

MR. TUBES

Mr. Tubes is a robust lamp design that combines pure functionality with graphic aesthetics. The black or white coated steel construction holds the LED tubes and gives the lamp an industrial look. The modern design is suitable for a variety of locations. The LED tube developed by Tonone is popular because of its wide range of uniform light. The lamp is dimmable and thanks to the adjustable steel cables, it can be hung at any desired height.



Mr. Tubes is available as a single or double pendant lamp, wall lamp, and as a chandelier. You can also create your own composition by connecting multiple lamps together with Mr. Tubes LED Connect.

The Mr. Tubes LED wall lamp and chandelier is characterized by the adjustable LED tube. The driver of the lamp is located on the fixture and is adjustable. The wing nut in solid brass is included to adjust the tube to personal preference. In addition to being a functional tool, the wing nut is integrated into the design of the lamp, making it a distinctive visual element.

[MORE INFO](#)

ELLA

Most of Tonone's lamps have a shade that is mainly made of powder-coated aluminum. Ella makes the difference. The lamp is equipped with a glass shade that is mouth-blown. The glass provides a natural and pleasant diffusion of light, so that the room is evenly and atmospherically illuminated.



Ella is a real eye-catcher and steals the show in any interior. What's exciting about the lamp is that you can customize it yourself. The light source sits on a tripod stand with brass details, which is available in both black and white. The stand is fitted with a glass shade that is also available in two color variants: transparent or in a neutral shade of grey. Ella is very suitable as a table lamp and comes into its own on a sideboard or in a modern wall cabinet.

[MORE INFO](#)

MEET THE DESIGNER

Anton de Groof was born in 1967 in Nuenen. With a father who worked as a technical production manager and designer of fencing, his parental home was littered with cardboard mechanisms. A fertile soil for De Groof's fascination with traditional mechanics and old tools.

Anton started the furniture brand Masimo in 1993 with a friend. Ten years later he continues on alone. First with the design of tables and chairs, later with interior and lighting. For example, he sets up 130 stores for a successful clothing brand. For the chain's head office, he designs a lamp as well as the interior.

[READ MORE](#)



CONTACT

For media inquiries, please send an email to communicatie@tonone.com. We are open to collaborations and interviews to share the story of our brand. We appreciate your interest and look forward to connecting with you.

[MORE IMAGES](#)



TONONE

Veemarktkade 8 – 6117 | 5222 AE Den Bosch | The Netherlands
info@tonone.com | www.tonone.com | +31 (0) 85 782 13 33



tonone_official